

Insulator Terminal - mm Size

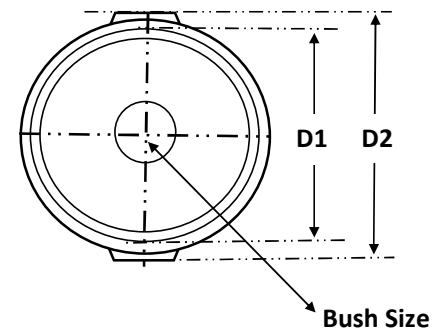

Insulator Terminal SM-35. SM-51. SM-76

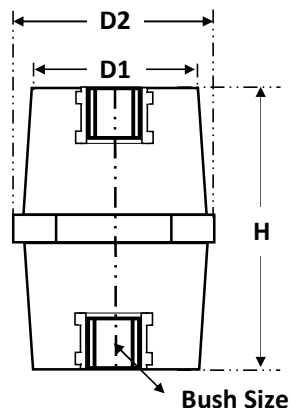

Product Code	Bush Size	H	D1	D2	Insert (embedded) Pieces			Strength			Insulation Performance	Electrical Properties		
					Nut Specifications	Screw Hole Depth	Nut Material	Tension in the axial direction	Bending	Tightening Torgue		Operating Voltage	Pulse Voltage	Leakage Currentat 2000V Operating Voltage
SM-35	M 8	35	28	32	M 8	10.0 mm	Copper	3000 N	4000 N	12N/m	>500mΩ	600V	5000V	< 1mA
SM-51	M 8	51	30	36	M 8	10.5 mm	Copper	3000 N	5000 N	15N/m	>1000mΩ	600V	5000V	< 1mA
SM-76	M 10	76	35	50	M 10	13.5 mm	Copper	4000 N	5000 N	20N/m	>1500mΩ	1500V	10000V	< 1mA