

# U-GLAND - CW Type

## STANDARD

B.S.6121 PART - 1 : 1989

IEC 62444 : 2010

IP Rating : IP 66

## APPLICATION

Single compression Outdoor or Indoor, for use with all types of SWA Cables

## FUNCTION

Provides mechanical cable retention and electrical continuity via Armour wire termination.

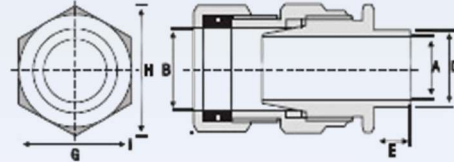

Material : Brass / Nickel Plated

All Dimensions Are Millimetre

GLAND SIZE	ENTRY THREAD		CABLE ACCEPTANCE DETAIL			ACROSS FLAT G	ACROSS CORNER H
	DIA. D	LENGTH MINIMUM E	DIAMETER MIN. MAX. A	DIAMETER MIN. MAX. B	ARMOUR DIAMETER		
20 SS	20	15	8.0 - 11.8	8.2 - 12.9	0.9 / 1.25	24.0	27.0
20 S	20	15	8.0 - 11.8	12.9 - 17.2	0.9 / 1.25	24.0	27.0
20 L	20	15	11.0 - 14.0	15.5 - 20.8	0.9 / 1.25	27.7	31.0
25 S	25	15	12.0 - 17.0	17.5 - 24.0	1.25 / 1.60	31.5	35.0
25 L	25	15	13.0 - 20.3	24.0 - 27.2	1.25 / 1.60	35.0	39.0
32 S	32	15	17.0 - 24.0	25.0 - 31.0	1.60 / 2.00	43.0	47.5
32 L	32	15	19.0 - 26.2	26.7 - 34.0	1.60 / 2.00	43.0	47.5
40 S	40	20	23.0 - 30.0	31.0 - 38.5	1.60 / 2.00	51.5	57.0
40 L	40	20	25.0 - 32.2	33.0 - 40.5	1.60 / 2.00	51.5	57.0
50 S	50	20	31.5 - 38.2	39.4 - 46.8	2.00 / 2.50	58.5	65.0
50 L	50	20	36.5 - 44.0	45.7 - 53.2	2.00 / 2.50	66.0	73.0
63 S	63	20	42.5 - 50.0	52.1 - 59.0	2.50	72.0	80.0
63 L	63	20	49.1 - 56.0	58.4 - 66.0	2.50	80.0	89.0
75 S	75	20	54.5 - 62.0	64.8 - 72.0	2.50	86.5	97.0
75 L	75	20	60.5 - 68.0	71.1 - 78.0	2.50	94.0	105.0
90 S	90	20	66.0 - 76.0	77.0 - 86.0	2.50 / 3.15	106.0	118.0
90 L	90	20	66.0 - 79.0	77.0 - 90.0	2.50 / 3.15	106.0	118.0
CW 100	100	25	80.0 - 90.9	92.0 - 101.5	3.15 / 4.00	123.0	135.3
CW 115	115	25	87.0 - 97.9	101 - 110.3	3.15 / 4.00	133.4	146.7