

U-GLAND

CW Type

STANDARD

B.S.6121 PART - 1 : 1989

IP Rating : IP 65

APPLICATION

Single compression Outdoor or Indoor, for use with all types of SWA Cables

FUNCTION

Provides mechanical cable retention and electrical continuity via Armour wire termination.

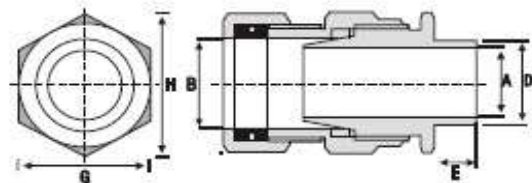

Material : Brass / Nickel Plated

All Dimensions Are Milimeter

| GLAND SIZE | ENTRY THREAD | | CABLE ACCEPTANCE DETAIL | | | ACROSS FLAT G | ACROSS CORNER H |
|------------|--------------|------------------|-------------------------|----------------------|-----------------|---------------|-----------------|
| | DIA. D | LENGTH MINIMUM E | DIAMETER MIN. MAX. A | DIAMETER MIN. MAX. B | ARMOUR DIAMETER | | |
| 20 S | 20 | 15 | 8.0 - 11.8 | 12.9 - 17.2 | 0.9 / 1.25 | 24.0 | 27.0 |
| 20 L | 20 | 15 | 11.0 - 14.0 | 15.5 - 20.8 | 0.9 / 1.25 | 27.7 | 31.0 |
| 25 S | 25 | 15 | 12.0 - 17.0 | 17.5 - 24.0 | 1.25 / 1.60 | 31.5 | 35.0 |
| 25 L | 25 | 15 | 13.0 - 20.3 | 24.0 - 27.2 | 1.25 / 1.60 | 35.0 | 39.0 |
| 32 S | 32 | 15 | 17.0 - 24.0 | 25.0 - 31.0 | 1.60 / 2.00 | 43.0 | 47.5 |
| 32 L | 32 | 15 | 19.0 - 26.2 | 26.7 - 34.0 | 1.60 / 2.00 | 43.0 | 47.5 |
| 40 S | 40 | 20 | 23.0 - 30.0 | 31.0 - 38.5 | 1.60 / 2.00 | 51.5 | 57.0 |
| 40 L | 40 | 20 | 25.0 - 32.2 | 33.0 - 40.5 | 1.60 / 2.00 | 51.5 | 57.0 |
| 50 S | 50 | 20 | 31.5 - 38.2 | 39.4 - 46.8 | 2.00 / 2.50 | 58.5 | 65.0 |
| 50 L | 50 | 20 | 36.5 - 44.0 | 45.7 - 53.2 | 2.00 / 2.50 | 66.0 | 73.0 |
| 63 S | 63 | 20 | 42.5 - 50.0 | 52.1 - 59.0 | 2.50 | 72.0 | 80.0 |
| 63 L | 63 | 20 | 49.1 - 56.0 | 58.4 - 66.0 | 2.50 | 80.0 | 89.0 |
| 75 S | 75 | 20 | 54.5 - 62.0 | 64.8 - 72.0 | 2.50 | 86.5 | 97.0 |
| 75 L | 75 | 20 | 60.5 - 68.0 | 71.1 - 78.0 | 2.50 | 94.0 | 105.0 |
| 90 S | 90 | 20 | 66.0 - 76.0 | 77.0 - 86.0 | 2.50 / 3.15 | 106.0 | 118.0 |
| 90 L | 90 | 20 | 66.0 - 79.0 | 77.0 - 90.0 | 2.50 / 3.15 | 106.0 | 118.0 |
| CW 100 | 100 | 25 | 80.0 - 90.9 | 92.0 - 101.5 | 3.15 / 4.00 | 123.0 | 135.3 |
| CW 115 | 115 | 25 | 87.0 - 97.9 | 101 - 110.3 | 3.15 / 4.00 | 133.4 | 146.7 |